

A47 North Tuddenham to Easton Dualling

Scheme Number: TR010038

Volume 2 **2.1 Location Plan**

APFP Regulation 5(2)(o)

Planning Act 2008

Infrastructure Planning (Applications: Prescribed
Forms and Procedure) Regulations 2009

March 2021

Infrastructure Planning

Planning Act 2008

**The Infrastructure Planning
(Applications: Prescribed Forms and
Procedure) Regulations 2009**

The A47 North Tuddenham to Easton
Development Consent Order 202[x]

LOCATION PLAN

Regulation Number:	5(2)(o)
Planning Inspectorate Scheme Reference	TR010038
Application Document Reference	TR010038/APP/2.1
Author:	A47 North Tuddenham to Easton Dualling Project Team, Highways England

Version	Date	Status of Version
Rev.0	March 2021	Application Issue

CONTENTS

1	INTRODUCTION.....	1
2	SCHEDULE OF PLANS IN THIS APPLICATION DOCUMENT.....	2

1 INTRODUCTION

- 1.1.1 This Location Plan (this “Plan”) relates to an application made by Highways England (the “Applicant”) to the Secretary of State of Transport, via the Planning Inspectorate (the “Inspectorate”) under section 37 of the Planning Act 2008 (the “2008 Act”) for a Development Consent Order (DCO). If made, the DCO would grant consent for the A47 North Tuddenham to Easton Scheme (the “Scheme”).
- 1.1.2 The Scheme aims to relieve congestion, reduce journey times, encourage economic growth and improve our customers’ experience along the section of the A47 between North Tuddenham and Easton, west of Norwich, with a new dual carriageway running south of the existing A47 at Hockering and to the north of the existing A47 at Honingham. A detailed description of the Scheme can be found in Chapter 2 The Proposed Scheme of the Environmental Statement (ES) (**TR010038/APP/6.1**).
- 1.1.3 This Plan comprises part of the suite of application documentation and is included in the application for a DCO in compliance with Regulations 5(2)(o) of the Infrastructure Planning (Applications: Prescribed Forms and Procedure) Regulations 2009 (the “2009 Regulations”), which require:
- 5(2)(o) “any other plans, drawings and sections necessary to describe the proposals for which development consent is sought, showing details of design, external appearance, and the preferred layout of buildings or structures, drainage, surface water management, means of vehicular and pedestrian access, any car parking to be provided, and means of landscaping;”*
- 1.1.4 Although Regulation 5(2)(o) does not expressly mention location, the Planning Inspectorate’s Advice note six: Preparation and submission of application documents (June 2012: version 5) suggests (at Appendix 1) that an application for development consent may include the submission of a location plan under Regulation 5(2)(o).
- 1.1.5 Therefore, this Plan has been included in the application documentation to identify the location of the proposed development in its wider geographical context. As a consequence, this Plan uses a smaller scale than prescribed in Regulation 5(3) of the 2009 Regulations, but only so that this wider geographical context can be represented on a single sheet plan.
- 1.1.6 As these Plans are part of the application documentation, they should be read alongside and are informed by the other application documentation.

2 SCHEDULE OF PLANS IN THIS APPLICATION DOCUMENT

Document Title	DCO Document Number	Drawing Number	Rev
Location Plan, Regulation 5(2)(o)	TR010038/APP/2.1	HE551489-GTY-LSI-000-DR-CH-30001	C01

This drawing should not be relied on or used in circumstances other than those for which it was originally prepared and for which Sweco UK Ltd was commissioned. Sweco UK Ltd accepts no responsibility for this drawing to any party other than the person by whom it was commissioned. This drawing has been prepared on behalf of Galliford Try by Sweco UK Ltd for the titled project or named part thereof and should not be relied upon or used for any other project without an independent check being carried out as to its suitability and prior written authority of Galliford Try being obtained. Sweco UK Ltd accepts no responsibility or liability for the consequences of this drawing being used for a purpose other than the purposes for which it was commissioned. Any person using or relying on this drawing for such other purpose agrees, and will by such use or reliance be taken to confirm his/her agreement, to indemnify Sweco UK Ltd for all loss or damage resulting therefrom.

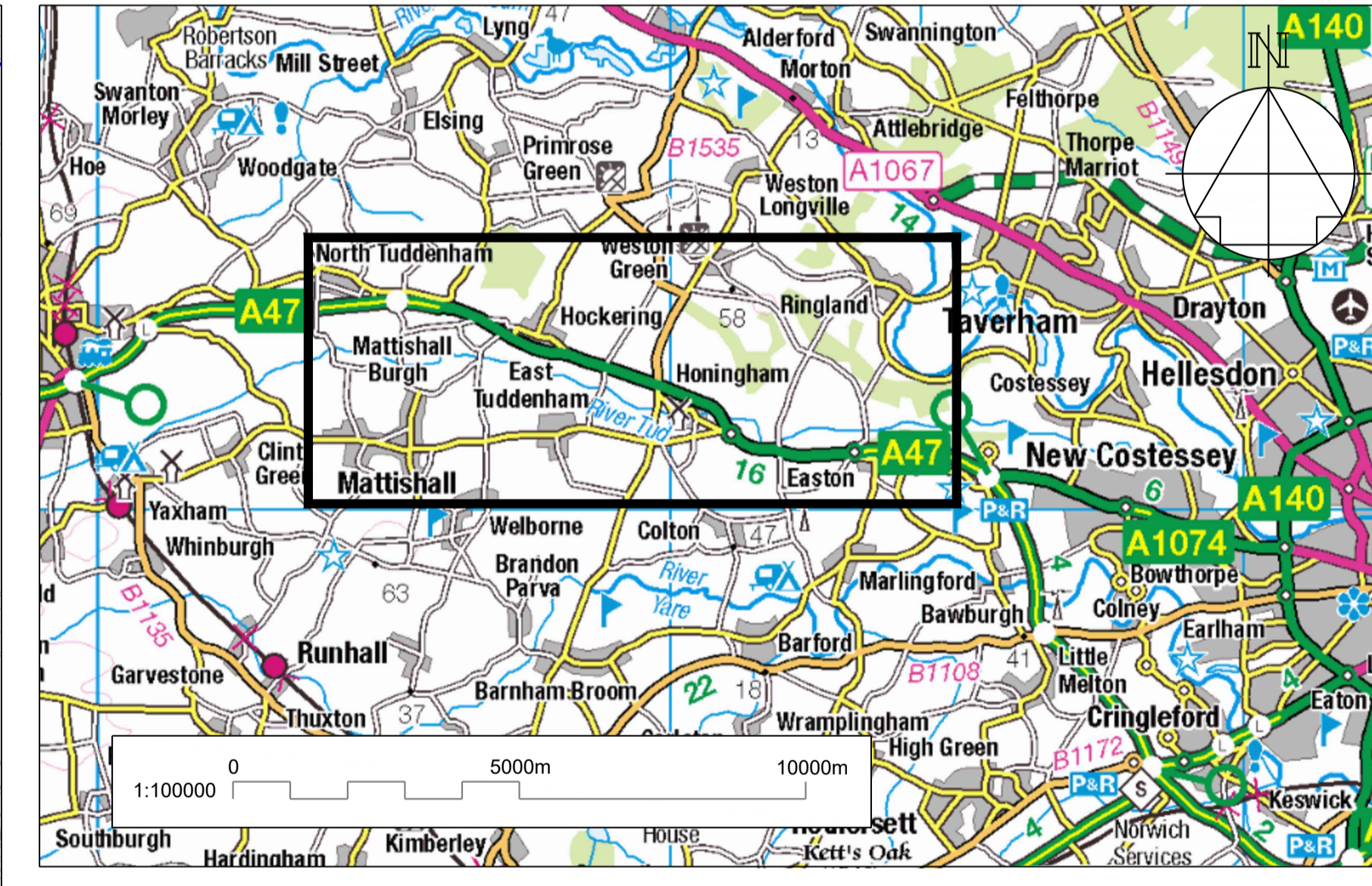
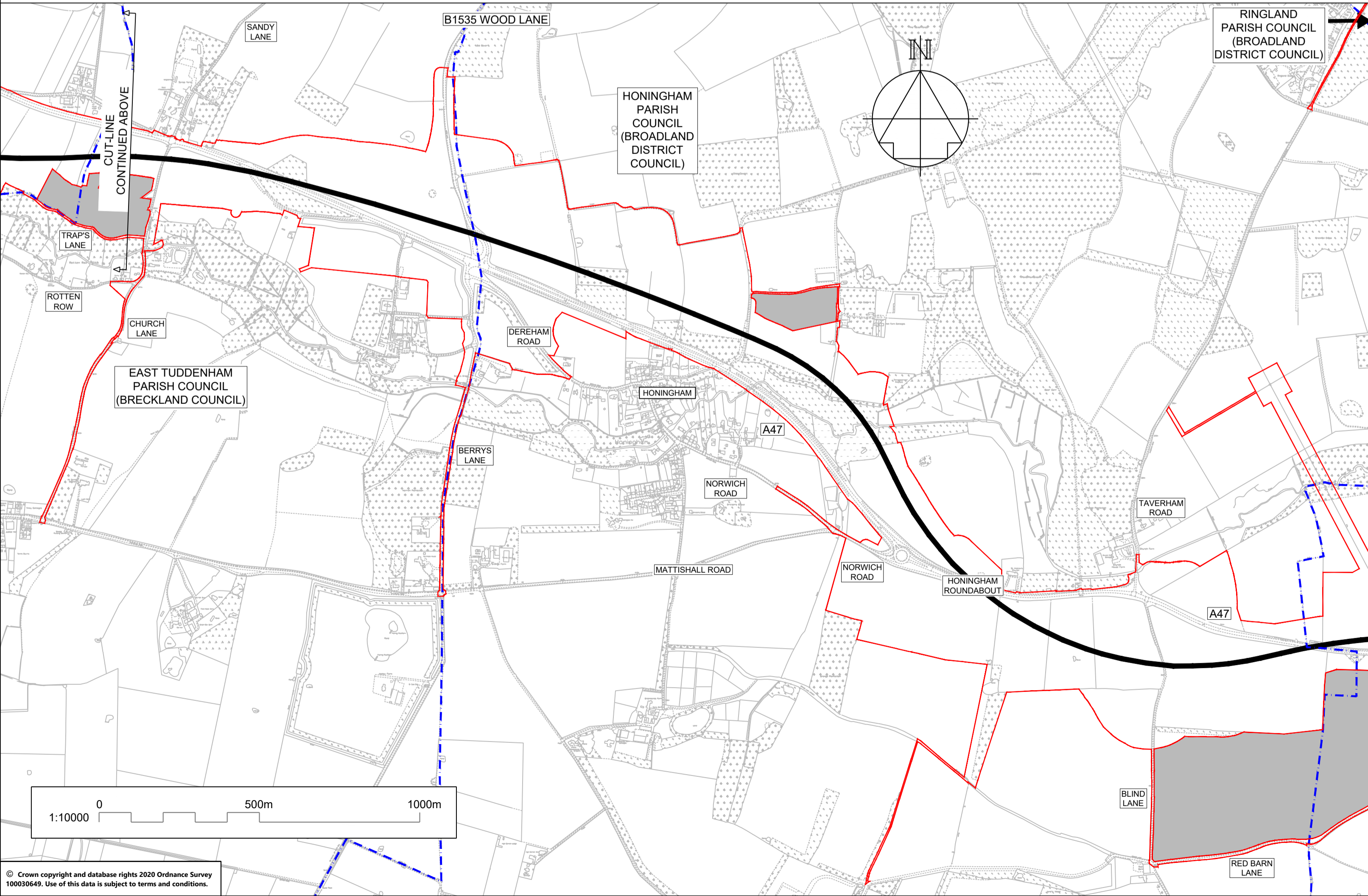
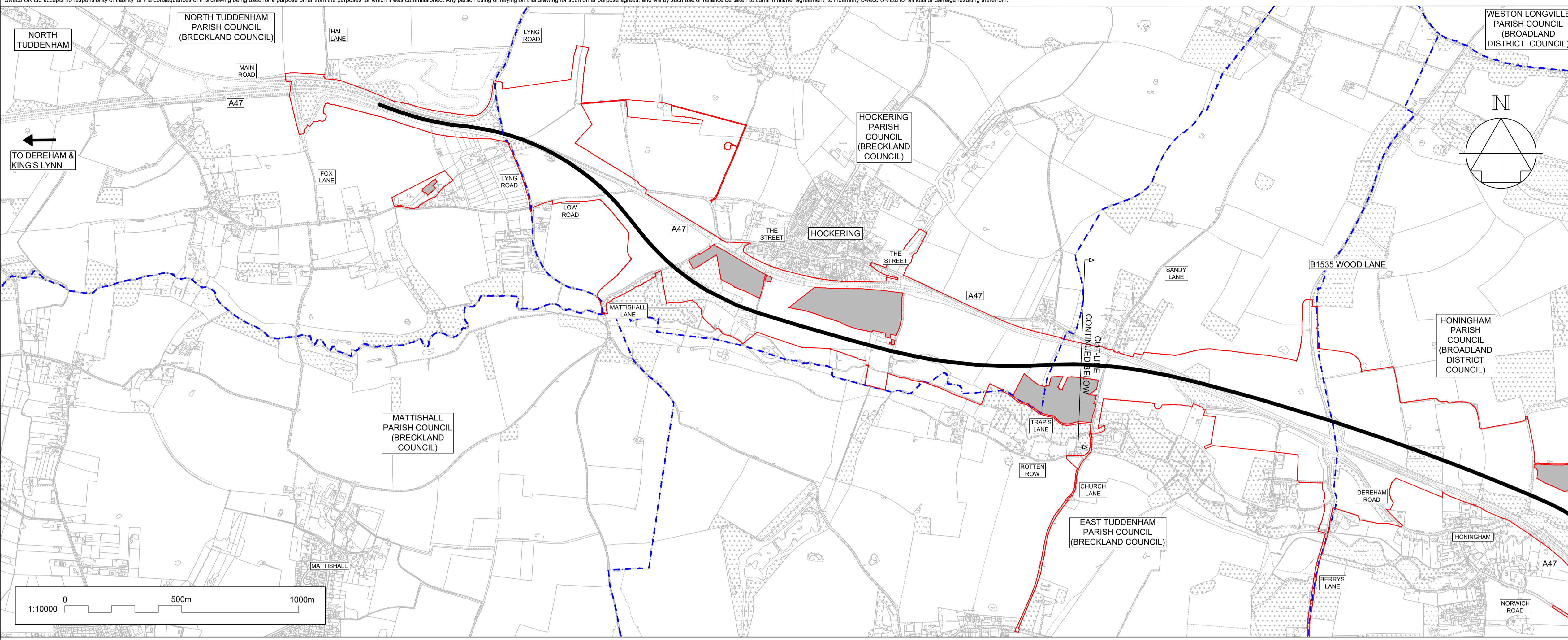

NOTES

Purpose of use
FOR DCO SUBMISSION

Development Consent Order Number / Document
TR010038/APP/2.1(A)

- THIS DRAWING SHOULD BE READ IN CONJUNCTION WITH ALL PLANS AND DOCUMENTS INCLUDED IN THE DCO APPLICATION.
- BASE MAP REPRODUCED FROM ORDINANCE SURVEY MAPPING.
- THIS PLAN IS SUBMITTED TO IDENTIFY THE LOCATION OF THE PROJECT AT A WIDER SCALE. IT IS NOT REQUIRED TO BE SUBMITTED UNDER REGULATIONS 5(2) OF THE INFRASTRUCTURE PLANNING (APPLICATIONS: PRESCRIBED FORMS & PROCEDURES) REGULATIONS 2009, SO IS PRESENTED AT A SMALLER SCALE THAN 1:2500

KEY TO SYMBOLS

- ORDER LIMITS
- A47 NORTH TUDDENHAM TO EASTON DUALING SCHEME
- AREA NOT INCLUDED IN ORDER LIMITS
- COUNCIL & PARISH BOUNDARIES
- SCHEME DESIGN

REV	DATE	REVISION NOTE	ORG	CHKD	APPD
P01	26/11/20	FIRST ISSUE	DPII	JHar	JHar
P02	07/12/20	DESIGN UPDATE	DPII	JHar	JHar
P03	26/02/21	FOR DCO SUBMISSION	ACus	JHar	JHar
C01	26/02/21	FOR DCO SUBMISSION	ACus	JHar	JHar

DESIGNER
SWECO

CONTRACTOR
GallifordTry

CLIENT
highways england

PROJECT TITLE
A47 NORTH TUDDENHAM TO EASTON DUALING

PROJECT STAGE
PCF STAGE 3

DRAWING TITLE
LOCATION PLAN REGULATION 5(2)(o)

SUITABILITY
AUTHORISED AS STAGE 3 COMPLETED

SHEET SIZE	SCALE	STATUS	REVISION
A1	AS SHOWN	A3	C01

DRAWING NUMBER
HE551489-GTY-LSI-000-DR-CH-30001